

REVISIONS		
REV. NO.	DESCRIPTION	DATE

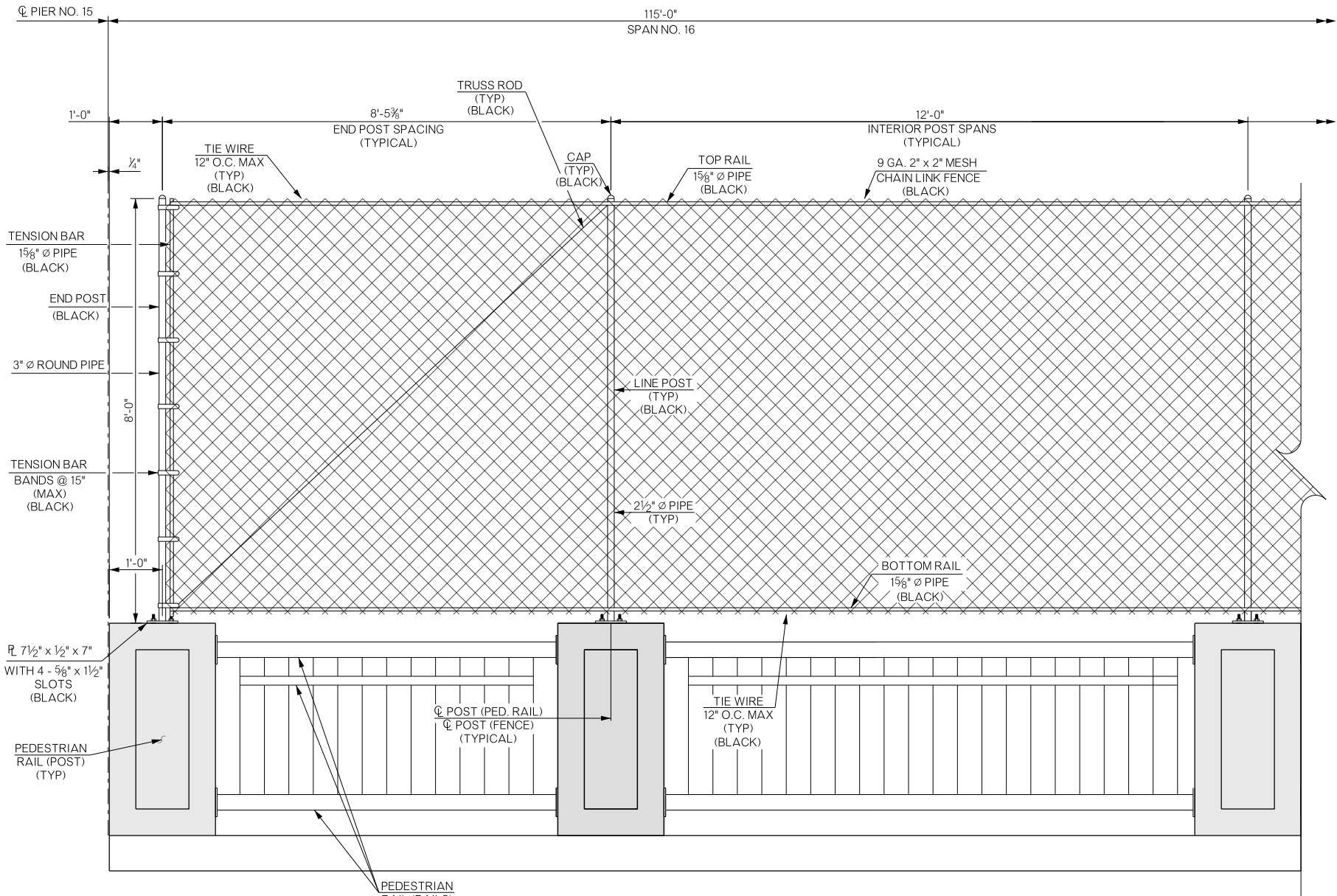

DETAIL "A"
(SEE NOTES, THIS SHEET)

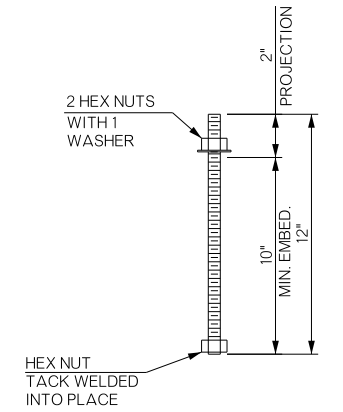

ANCHOR DETAIL
5/8" ϕ ASTM A36 THREADED ROD W/ HARDENED STEEL, 2-HEX NUTS AND 1-WASHER AS SHOWN.

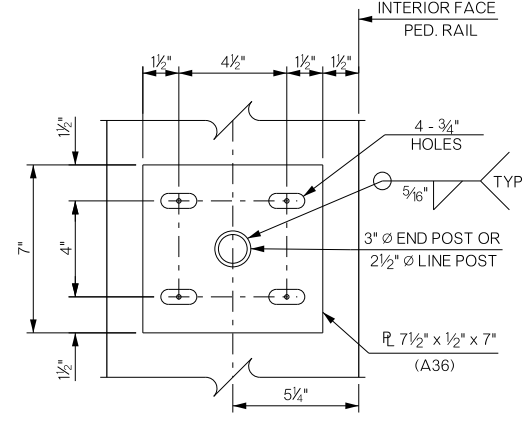

PLAN VIEW OF POST ASSEMBLY
U-BOLTS NOT SHOWN FOR CLARITY

NOTES:

MATERIALS:

- POSTS AND RAILS: ASTM A53 (GRADE B)
- TUBING: ASTM A500 (GRADE B)
- BASE PLATE AND FENCE ACCESSORIES: AASHTO M270, GRADE 36
- ANCHOR BOLTS SHALL BE OF ASTM A449, TYPE 1 THREADED ROD, GALVANIZED IN ACCORDANCE WITH SUB SECTION 724.06 IN THE STANDARD SPECIFICATIONS, NUTS SHALL CONFORM TO ASTM A563DH, WASHERS SHALL CONFORM TO ASTM F436. NUTS AND WASHERS SHALL BE GALVANIZED IN ACCORDANCE WITH SUBSECTION 724.06 OF THE STANDARD SPECIFICATIONS.
- FENCING SHALL BE CLASS A, TYPE IV CHAIN LINK FENCE IN ACCORDANCE WITH SUBSECTION 732.07 OF THE STANDARD SPECIFICATIONS. THE FENCE IS TO BE 8' IN HEIGHT, VINYL-COATED (BLACK) WITH COATED (BLACK) STEEL FENCE POSTS, BARS, RAILS, BANDS AND BASE PLATE.

LAYOUT:

- FENCE LAYOUT SHALL CONFORM TO VERTICAL AND HORIZONTAL ALIGNMENT OF BRIDGE "A". FENCE POSTS SHALL BE SET PLUMB (TRUE VERTICAL). STRETCHING AND SECURING OF FABRIC TO POSTS SHALL NOT OCCUR UNTIL SEVEN (7) DAYS HAVE ELAPSED FROM POURING OF PEDESTRIAN RAIL CONCRETE POSTS OR FULL CONCRETE STRENGTH HAS BEEN ATTAINED.

MISCELLANEOUS:

- ALL VINYL-COATING DAMAGED IN TRANSPORTATION OR HANDLING SHALL BE REPAIRED TO THE SATISFACTION OF THE ENGINEER.
- ALL EXPOSED EDGES SHALL BE SMOOTH.
- CHAIN LINK FABRIC SHALL BE PLACED ON THE INSIDE (SIDEWALK SIDE) OF THE POSTS.
- ALL COSTS OF MATERIAL, LABOR, EQUIPMENT AND INCIDENTALS NECESSARY FOR CONSTRUCTION OF FENCING SHALL BE INCLUDED IN THE PRICE BID PER LINEAR FOOT OF "FENCE-STYLE CLF (8' HIGH, CLASS A)".

DETAIL "A" NOTES:

- END POST: 3" DIA.
- LINE POST: 2 1/2" DIA.
- TOP RAIL: 1 5/8" DIA.
- BOTTOM RAIL: 1 5/8" DIA.
- TENSION BAR: 3/8" X 3/4" BAR
- TENSION BAR BAND: 3/4" X 0.074" WITH 5/16" DIA. X 1/4" BOLT
- TIE WIRE: 9 GA.
- FABRIC: 9 GA., MESH WITH KNUCKLING SELVAGE
- CAPS: CAP ALL POSTS, CAPS SHALL CONFORM TO ASTM F626-14
- TRUSS ROD: 5/16" MIN. ROUND WITH TIGHTENERS AND FITTINGS

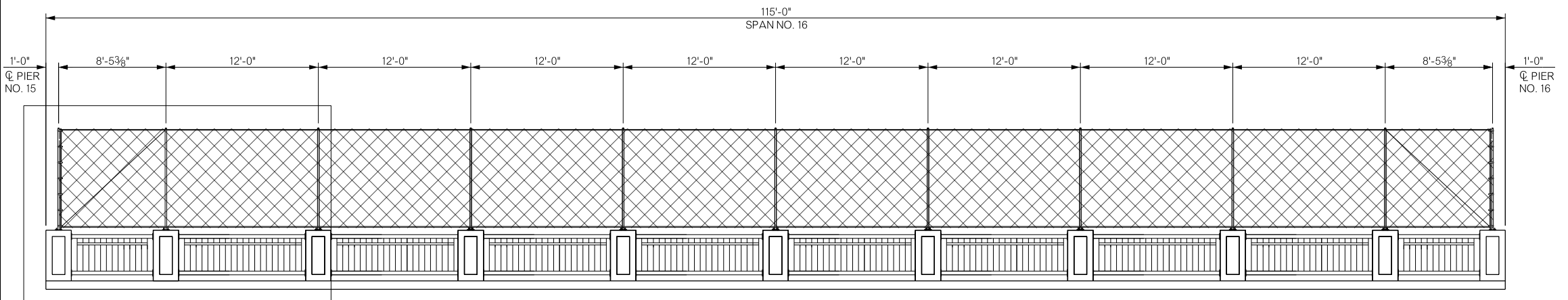

ELEVATION

FOR DETAILS OF PILASTER VIEWS, SEE SHEET B076
FOR STANDARD REFERENCE SEE STD. RWF3-2

THROW FENCE PAY QUANTITIES				
DESCRIPTION	UNIT	PHASE I	PHASE II	TOTAL
FENCE - STYLE CLF (8' HIGH, CLASS A)	LF	112.92	112.92	225.84

DETAILS OF THROW FENCE (SHEET 1 OF 2)	BRIDGE "A" S.H. 33 OVER COTTONWOOD CREEK		LOGAN COUNTY	
	Design	GT	5/16	
	Detail	RBS	5/16	
	Check	TT	5/16	
Squad: PEARSON		Engr: HERNANDEZ		
STATE OF OKLAHOMA		DEPARTMENT OF TRANSPORTATION		JOB/PIECE NO. 21860(04)
				SHEET NO. B075

SEE DETAIL "A", THIS SHEET